

SM-D211MCVA

CAMERA

2MP Full-color HD Analog Turret Camera



- 1080P real-time image, high resolution, true color
- AHD / TVI / CVI lossless HD video output
- Support 960H CVBS output
- Up to 1000 TVL resolution
- CMOS progressive scan, perfectly capturing the moving object
- Support OSD menu
- High speed, long distance and real time transmission
- 24/7 full color imaging
- LED can be turned on or off automatically
- Support noise reduction function
- 10 ~ 20m LED distance
- IP67
- Support coaxial audio transmission
- Support COC

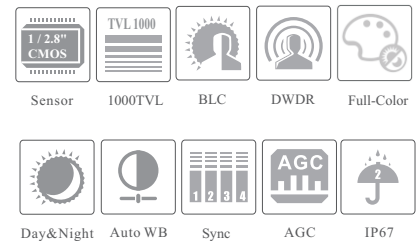

SM-D211MCVA

2MP Full-Color HD
Analog Turret Camera

SPECIFICATIONS

Model	SM-D211MCVA
Specifications	
Camera	
Image Sensor	1 / 2.8" CMOS
Resolution	2MP
Image Size	1920 x 1080
Video Output	AHD / TVI / CVI / CVBS
Audio	1CH built-in MIC
Image System	PAL / NTSC
Electronic Shutter	Auto
LED Distance	10 ~20 m
Frame Rate	30fps(60Hz); 25fps (50Hz)
Min. Illumination	0 lux (LED ON)
Lens	2.8mm
Lens Mount	M12
S / N Ratio	≥52dB (AGC OFF)
Ingress Protection	IP 67
Functions	
Function Control	OSD (COC Control)
Smart LED	Manual or Auto mode
ICR	NO
Digital WDR	Yes
Digital DNR	Yes, 2D DNR
AGC	Yes
Auto White Balance	Yes
BLC	Yes
Front Light Compensation	NO
Defog	NO
HLC	Yes
Sharpness	Yes
Contrast	Yes
Image Setting	Yes
Defect Correction	Auto
Language	Chinese and English
Angle Adjustment	Pan: 0°~360°; Tilt: 0°~75°; Rotation: 0°~360°
Others	
Power Supply	DC12V (± 15%)
Power Consumption	LED OFF : < 1W; LED ON : < 4W
Working Environment	- 30 °C ~ 50 °C, 10 % ~ 90 % (relative humidity)
Dimensions (mm)	Φ 94.6 x 82.8
Weight (net)	Approx. 0.39KG

DIMENSIONS

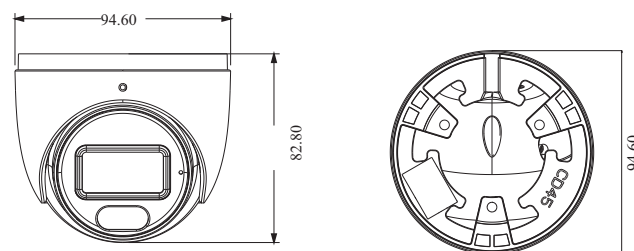

AVAILABLE ACCESSORIES



AVAILABLE MODEL

Available Model	SM-D211MCVA
-----------------	-------------