

CAMERA

SM-D511MCVA

5MP Full-color HD Analog Turret Camera



- 5MP 20fps/4MP real-time image, high resolution, true color
- AHD / TVI / CVI standard and lossless video output
- Up to 1500 TVL resolution
- CMOS progressive scan, perfectly capturing the moving object
- DWDR
- Support OSD menu
- High speed, long distance and real time transmission
- LED can be turned on or off automatically
- 24/7 full color image
- 10~20m LED view distance
- IP67 ingress protection
- Support COC
- Support coaxial audio transmission (Temporarily only valid in TVI signal mode)

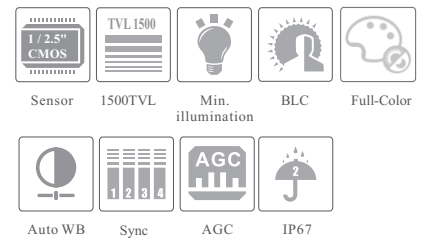

SPECIFICATIONS

Model	SM-D511MCVA
Specifications	
Camera	
Image Sensor	1 / 2.5 "CMOS
Resolution	5MP
Image Size	2560 x 1936
Video Output	AHD / TVI / CVI
Audio	1CH built-in MIC
Image System	PAL / NTSC
Electronic Shutter	Auto
LED Distance	10 ~ 20 m
Frame Rate	5MP@20fps/4MP@30fps
Min. Illumination	0 lux (LED ON)
Lens	3.6 mm
Lens Mount	M12
S / N Ratio	≥52dB (AGC OFF)
Ingress Protection	IP 67
Functions	
Function Control	OSD (COC Control)
Smart LED	Manual or Auto mode
Digital WDR	Yes
Digital NR	Yes, 2D DNR
Global Exposure	Yes
Central Exposure	No
AGC	Yes
Auto White Balance	Yes
BLC	Yes
Front Light Compensation	No
Contrast	Yes
Sharpness	Yes
Image Setting	Yes
Defect Correction	Auto
Language	Chinese and English
Angle Adjustment	Pan: 0°~360°; Tilt: 0°~75°; Rotation: 0°~360°
Others	
Power Supply	DC12V (± 15%)
Power Consumption	LED OFF : < 1W; LED ON : < 3W
Working Environment	- 30 °C ~ 50 °C, 10 % ~ 90 % (relative humidity)
Dimensions (mm)	Φ 94.6 x 82.8
Weight (net)	Approx. 0.39KG

DIMENSIONS

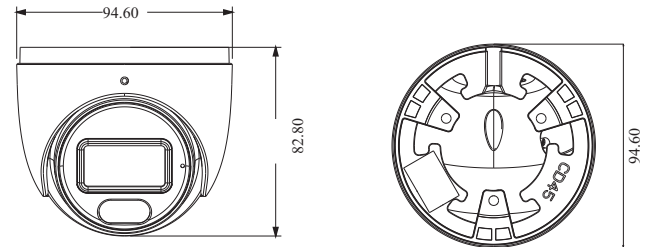

AVAILABLE ACCESSORIES



AVAILABLE MODEL

Available Model	SM-D511MCVA
-----------------	-------------